

The wide variety of systems for controlling and adjusting light brings great advantages:

Flexibility, light can be adjusted to any place or to any activity.

Looks, lighting can be chosen to suit the surroundings.

Comfort, the light strength can be personalised.

Energy efficiency, great savings on energy costs.



ANALOGUE SYSTEMS AND SQUARE

The rotating manual control, reference 71R/11050/33, can control up to 50 adjustable electronic ballasts 1 – 10 V, and can act as a switch for up to 8 ballasts. The cut-off capacity on the system can be increased to the 50 units by fitting an auxiliary relay to switch the luminaires on/off.

71R/11050/33

The sliding manual control, reference 71L/11050/33, can control up to 50 adjustable electronic ballasts 1 – 10 V, and can act as a switch for up to 20 ballasts. The cut-off capacity on the system can be increased to the 50 units by fitting an auxiliary relay to switch the luminaires on/off.

71L/11050/33

The button panel connected to the control bus enables the following operations:

- Switching on to one of the four pre-set lighting levels 100%, 75%, 50%, 25%. (These levels are activated automatically by pressing buttons 3 and 4 during the installation stage).
- Raising and lowering the level as required.
- (Manual adjustment):
- Switching off.

76/7/33

The panel also has an infra-red receiver to control the system by remote control 73/IR/04.

Remote control 73/IR/04 contains the same functions as the button panel, as described below:

- Switching on to one of the four pre-set lighting levels 100%, 75%, 50%, 25%. (These levels are activated automatically by pressing buttons 3 and 4 during the installation stage).
- Raising and lowering the level as required.
- (Manual adjustment):
- Switching off.

73/IR/04

It is also an essential device if a more complex program is to be installed onto the system.

Sensor

Stand-alone 1-10v multisensory with a motion and lighting functions to perform an analogic control to adjust an installation light level to a constant value, to get the goal of optimized energy installation consumption.



73/503200

DALI multisensor with a motion and lighting sensor to perform a digital control to adjust an installation light level to a constant value, to get the goal of optimized energy installation consumption.



73/53

PIR presence /absence motion detector for non-dimmable high bay luminaires, integrated in a DALI system. Optional Clip-on masks to customize the detection area, and also IP65 & -30°C versions available.



73/317/33

The sensor can be fitted directly to the ceiling or to the luminaire, fixed to the tube, with bracket 71/20/T5 (for fluorescent tubes T5) or 71/20/T26 (for fluorescent tubes T26).

Lamp sensor T5

71/20/T5

Lamp sensor T26 support bracket

71/20/T26

Remote control to program sensors: 73/SW/33, 73/AN/33 y 73/DA/33. Infrared communication.

73/IRPROG/04

Sensor

Recessed sensor designed to control nondimmable luminaries. Sensor will switch on/off the lights, as the room is occupied/empty. In addition the user can program a threshold illuminance level that the sensor will switch off the luminaries (remember that the luminaries are non-dimmable). The sensor could be used inside a luminary; plastic parts or glass diffusers cannot interfere with the signal. Users can program the sensor with the SA-IR-PROG remote control. Technical features: Power supply 220-240V AC 50Hz. Maximum load 2A. Illuminance range 200-900 lux.

73/SW/33

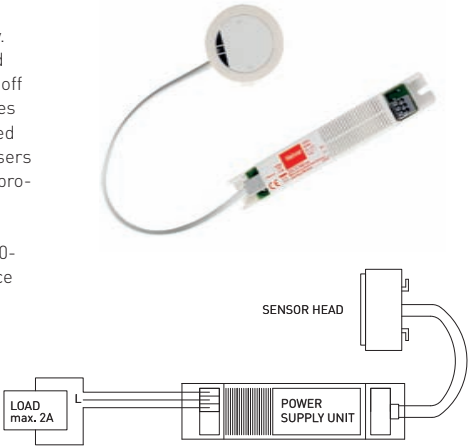

Recessed sensor designed to control 1-10V dimmable luminaries. Sensors have the following features: 1-10V dimming for sunlight and detection of presence. The sensor could be used inside a luminary; plastic parts or glass diffusers cannot interfere with the signal. Users can program the sensor with the SA-IRPROG remote control. Technical features: Power supply 220-240V AC 50Hz. Maximum load 2A and four 1-10V ballasts. Illuminance range 200-900 lux.

73/AN/33

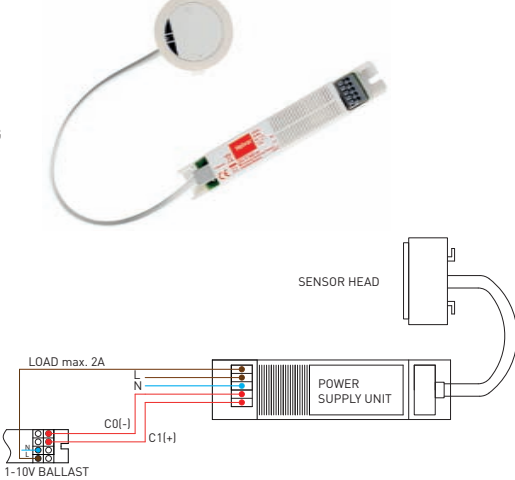

Recessed sensor designed to control DALI dimmable luminaries. Sensors have the following features: 1-10V dimming for sunlight and detection of presence. The sensor could be used inside a luminary; plastic parts or glass diffusers cannot interfere with the signal. Users can program the sensor with the SA-IRPROG remote control. Technical features: Power supply 220-240V AC 50Hz. Maximum load 2A and four 1-10V ballasts. Illuminance range 200-900 lux.

73/DA/33

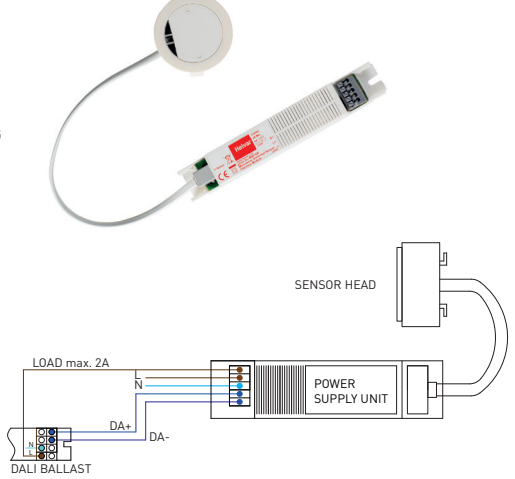

DALI systems

Light dimming controller for voltages 12-24V. It has five distinct mode of operation (selected via the dip-switches): on/off, push dimming, DALI, dimming 0-10V, dimming 1-10V.



73/DLP



73/DLS
Slave

Voltage source

DALI diver

The 71/LDRD2412504 DALI controller allows control of linear LED luminaires supplied 24V DC. The controller has 4 output channels with a maximum load of 1.25 amps per channel. The voltage source is adequate for the load as well as respecting the maximum output current. DALI bus connection (DA +; -DA, SC) must be made with shielded twisted pair cable. Bus cable sizes 1.5mm² 0.75mm² ~. Maximum length is 300m DALI bus with a section of 1.5mm² cable, according to standard protocol data. The DALI signal can be disturbed by currents outside the system that is highly connected mesh (screen) to the terminals as shown in the wiring diagram recommended. Maximum 64 DALI data bus.



+

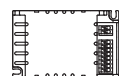

71/LDRD2412504

In a meeting room with items projected onto a screen, it is necessary to lower the general lighting and dim or block out natural light entering through the window, or even control the screen. The DALI system can also control the automatic curtains and screen, in addition to other ON/OFF lighting channels. For these occasions, there is the 4-relay module, controlled by DALI protocol, ref. 73/UR/DIN.



73/UR/DIN

250mA DALI bus feed, needed for DALI systems consisting of elements not included on the bus feed.



71/0250

DALI voltage dimmer 24V.
4 channels, 1250mA per channel.

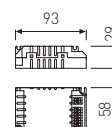

71/LDRD2412504



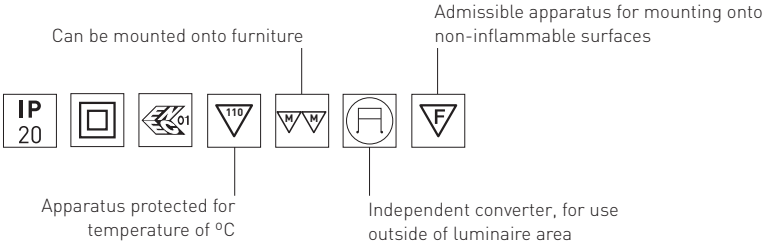

Power supply



71/LD3524
Power supply
120-240Vac/24V 35W.
Independent use.

IP 20

71/LD6024
Power supply
120-240Vac/24V 60W.
Independent use.

IP 20

71/LD10024
Power supply
120-240Vac/24V 96W.
Independent use.

IP 20

71/LD18024
Power supply
120-240Vac/24V 180W.
Independent use.

71/LDT06024
Power supply
120-240Vac/24V 60W.
Independent use.

IP 67

71/LDT9624
Power supply
120-240Vac/24V 96W.
Independent use.

IP 67

71/LDT15024
Power supply
120-240Vac/24V 150W.
Independent use.

IP 67